

TURN AND BANK INDICATOR - MAINTENANCE PRACTICES

1. General

- A. (1) The turn and bank indicator is a combination instrument located in the pilot's instrument panel to the left of control column. The indicator consists of an electrically driven, gyroscopic rate of turn indicator that operates only when aircraft battery switch is in the ON position. A fluid dampened inclinometer is also located in the instrument. The inclinometer consists of a curved, liquid filled glass tube in which a ball, moving with dampened motion, changes positions according to gravitational and centrifugal force acting upon airplane. An optional right located turn and bank indicator is also available. Trouble shooting and maintenance practices for the right turn and bank indicator are the same as for the left turn and bank indicator covered in this chapter.

2. Turn and Bank Indicator Removal/Installation

- A. Remove Turn and Bank Indicator (Refer to Figure 201).
- (1) Remove screws and washers securing removable flight panel (8) and slide flight panel (8) aft to gain access to back of turn and bank indicator (3).
 - (2) Remove two postlight assemblies (1) in accordance with procedures in Chapter 33, Lighting.
 - (3) Disconnect electrical connector (2), located on back of turn and bank indicator (3).
 - (4) Remove screws (4) securing indicator (3) to faceplate (7).
 - (5) Remove screws (5) and nuts (6) securing faceplate (7) to flight panel (8).
- B. Install Turn and Bank Indicator (Refer to Figure 201).
- (1) Position faceplate (7) to flight panel (8) and secure with screws (5) and nuts (6).
 - (2) Position indicator (3) to faceplate (7) and secure with screws (4).
 - (3) Connect electrical connector (2).
 - (4) Install two postlight assemblies (1) in accordance with procedures in Chapter 33, Lighting.
 - (5) Slide flight panel (8) forward and install screws and washers securing flight panel (8) to instrument panel.

Figure 201 : Sheet 1 : Turn and Bank Indicator Installation

A22306

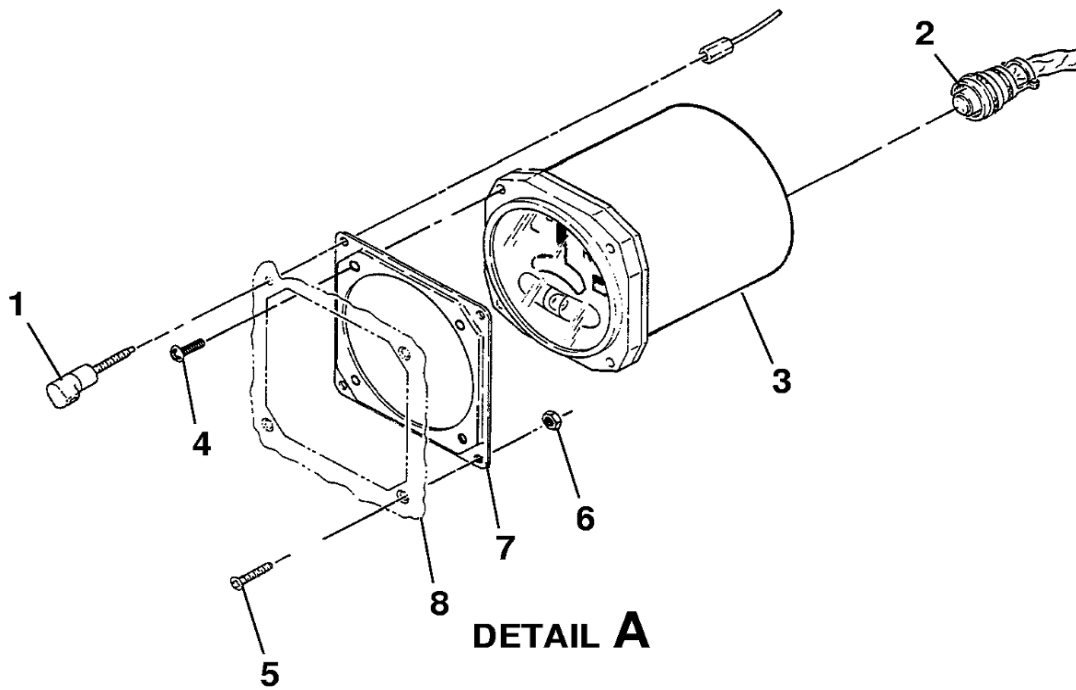
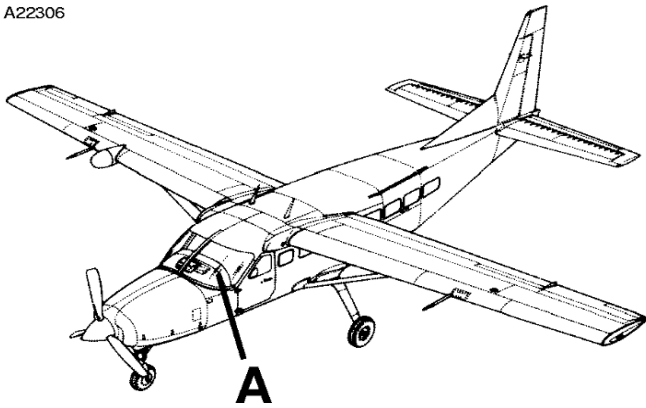

DETAIL A

- 1. POSTLIGHT ASSEMBLY
- 2. ELECTRICAL CONNECTOR
- 3. TURN-AND-BANK INDICATOR
- 4. SCREW
- 5. SCREW
- 6. NUT
- 7. FACEPLATE
- 8. FLIGHT PANEL

26107002
A2618X1185